

**Sealed Rechargeable Cylindrical cell Nickel Metal Hydride**

SC-4200 mAh

**Date Sheet**

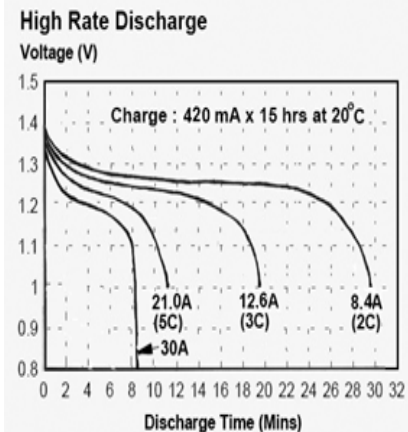
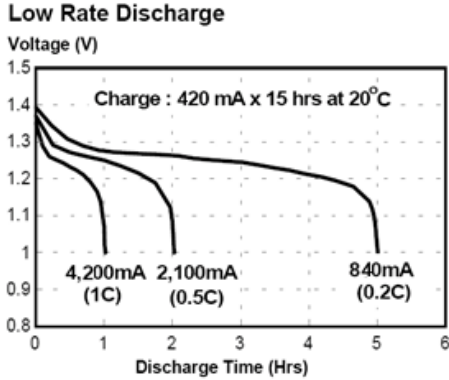
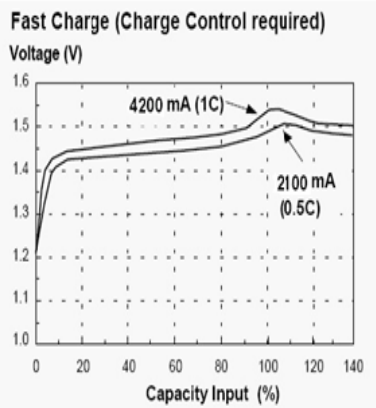
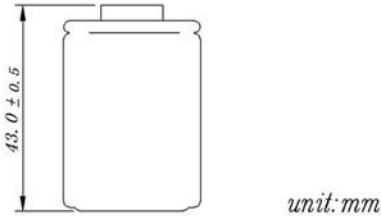
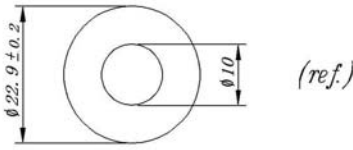

**Type**-----EastpowerSC4200  
**System**-----Sealed rechargeable Ni-MHCylindrical cell  
**Nominal Voltage**-----1.2V  
**Application**-----Discharge current 420mA to 30A (Continuous)  
**Capacity** (discharged at 0.2C to 1.0v at 20□)  
 Nominal 4200mAh  
 Minimum 4100mAh  
 Typical 4200mAh  
**Internal resistance** (at 1 kHz)  
 Fully charged,20□(approx)---1.6□1.8mΩ  
**Weight approx**-----69g  
**Dimensions**(including shrink sleeve)  
 -Diameter -----22.9 (±0.2mm)  
 -Height -----43.0(±0.5mm)  
**Cd content(%cell w)**:-----0%  
**Typical Discharge time&Avg.Voltage** (20□)  
 30A--510S--1.235V (TURBOMATCHER□ discharged at 30A to 0.9v at 20□)  
**Max.discharge current**(continuous)-----20C  
**Charging conditions**(20□)  
 standard charge-----420mA 14h  
 quick charge-----4200mA 1.1h  
 fast charge -----2A to 6A  
 Charge termination control recommended control parameter  
 -ΔV 5mV  
 DT/dt 0.8□/min(0.5-1C)  
 0.8□-1□/min(>1C)  
 TCO 40-45□  
**Timer** 105%nominal input  
**Continuous** 100mA maximum current for 1 year  
**Overcharge** No conspicuous deformation and/or leakage  
**Max.charging voltage** 1.5V at 420mA charging  
**Operation temperatures**(recommended)  
 Storage----- -20□ up to +35□  
 Discharge----- -20□ up to +50□  
 standard charge----- 0□ up to +40□  
 quickcharge,fastcharge--10□ upto+40□  
 permanent charge-----+10□ up to +45□  
**Life expectancy**(20□)----->500 cycles