

Sealed Rechargeable Cylindrical cell Nickel Metal Hydride
SC-3700 mAh

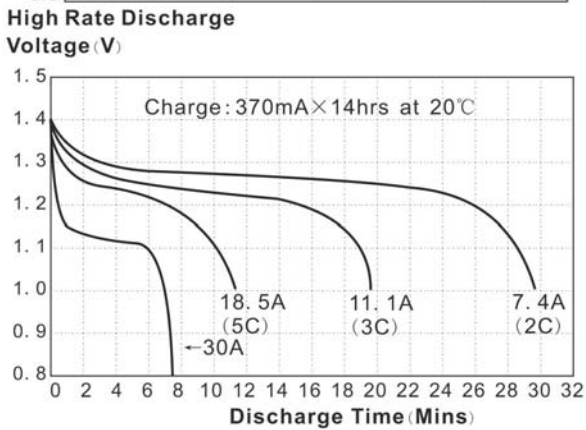
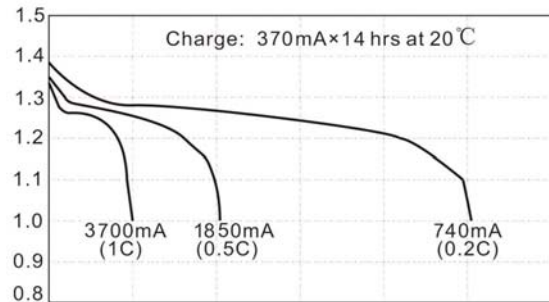
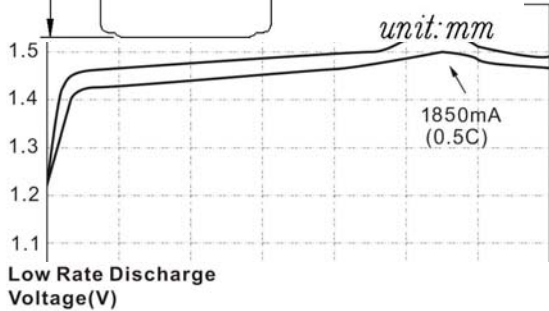
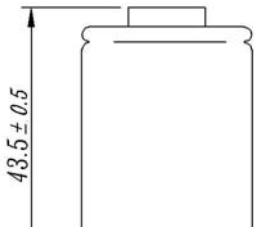
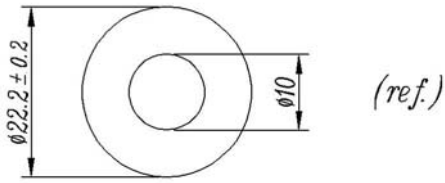

Date Sheet

Type-----EnrichpowerSC3700
System-----Sealed rechargeable Ni-MHCylindrical cell
Nominal Voltage-----1.2V
Application-----Discharge current 370mA to 30A (Continuous)
Capacity (discharged at 0.2C to 1.0v at 20□)
 Nominal 3700mAh
 Minimum 3600mAh
 Typical 3700mAh
Internal resistance (at 1 kHz)
 Fully charged, 20□ (approx)---4□6mΩ
Weight approx-----60g
Dimensions(including shrink sleeve)
 -Diameter -----22.2 (±0.2mm)
 -Height -----43.5(±0.5mm)
Cd content(%cell w):-----0%
Typical Discharge time&Avg. Voltage (20□)
 30A--440S--1.160V (TURBOMATCHER□ discharged at 30A to 0.9v at 20□)
Max.discharge current(continuous)-----20C
Charging conditions(20□)
 standard charge-----370mA 14h
 quick charge-----3700mA 1.1h
 fast charge -----2A to 6A
 Charge termination control recommended control parameter
 -ΔV 5mV
 DT/dt 0.8□/min(0.5-1C)
 0.8□-1□/min(>1C)
 TCO 40-45□
 Timer 105%nominal input
Continuous 100mA maximum current for 1 year
Overcharge No conspicuous deformation and/or leakage
Max.charging voltage 1.5V at 370mA charging
Operation temperatures(recommended)
 Storage-----20□ up to +35□
 Discharge-----20□ up to +50□
 standard charge----- 0□ up to +40□
 quickcharge,fastcharge--10□ upto+40□
 permanent charge-----+10□ up to +45□
Life expectancy(20□)----->500 cycles