

Sealed Rechargeable Cylindrical cell Nickel Metal Hydride

SC-4200 mAh

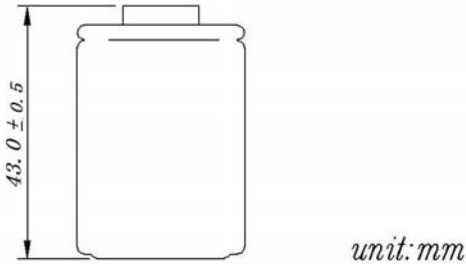
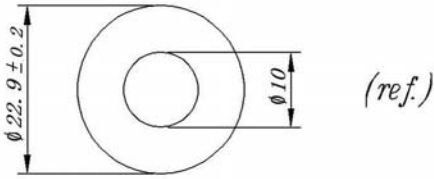

Date Sheet

-----EastpowerSC4200
 -----Sealed rechargeable Ni-MHCylindrical cell
Voltage-----1.2V
ion-----Discharge current 420mA to 30A (Continuous)
 v (discharged at 0.2C to 1.0v at 20□)
 4200mAh
 4100mAh
 4200mAh
resistance (at 1 kHz)
 ured,20□(approx)---1.6□1.8mΩ

rox-----69g
 s(including shrink sleeve)
 -----22.9 (±0.2mm)
 -----43.0(±0.5mm)
 (%cell w):-----0%
charge time&Avg. Voltage (20□)
 --1.235V (TURBOMATCHER□ discharged at 30A to 0.9v at 20□)
arge current(continuous)-----20C
onditions(20□)
 arge-----420mA 14h
 rge-----4200mA 1.1h

-----2A to 6A
 mination control recommended control parameter
 mV
).8□/min(0.5-1C)
 min(>1C)
 10-45□
er 105%nominal input
us 100mA maximum current for 1 year
ge No conspicuous deformation and/or leakage

Max.charging voltage 1.5V at 420mA charging

temperatures(recommended)
 rge----- -20□ up to +35□
 harge----- -20□ up to +50□
 lard charge----- 0□ up to +40□
 <charge,fastcharge--10□ upto+40□
 anent charge-----+10□ up to +45□
expectancy(20□)----->500 cycles

Fast Charge (Charge Control required)

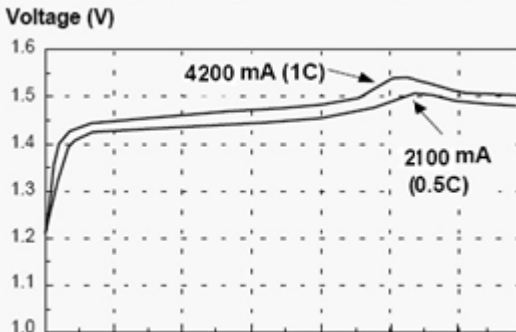

Low Rate Discharge

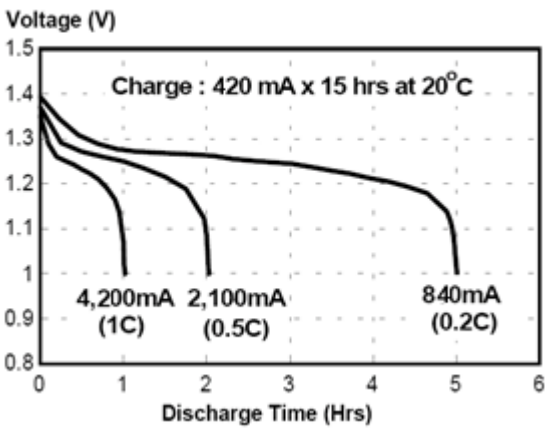

High Rate Discharge

